

الملحق عدد 4
أمثلة العشرات

 Restaurants

 Carburant

 Superm

 Maison Des Jeunes Kasserine

Salle Couverte 

BAYA home

Kasserine 

Centre international d'art contemporain de...
Vu récemment

 Cité Ouvrière
Vu récemment

Cite olympique
Vu récemment 

Google Maps

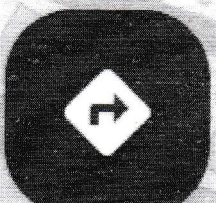
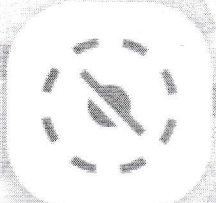

BOURQUIN

3308

3307

3306

3305

3304

3303

MAIRIE

Jardin Cité
Olympique

ENNE

 Restaurants

 Supermarchés

 Cafés

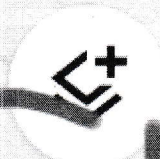

Cité des cadres
حي الإطارات



P17

حلاقة عصا



Foyer
Universitaire
de Kasserine



Hôtel Cillium
Vu récemment

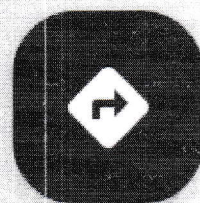
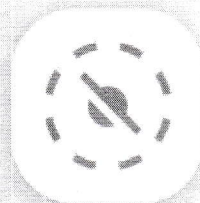

Google Maps

RORD

5887

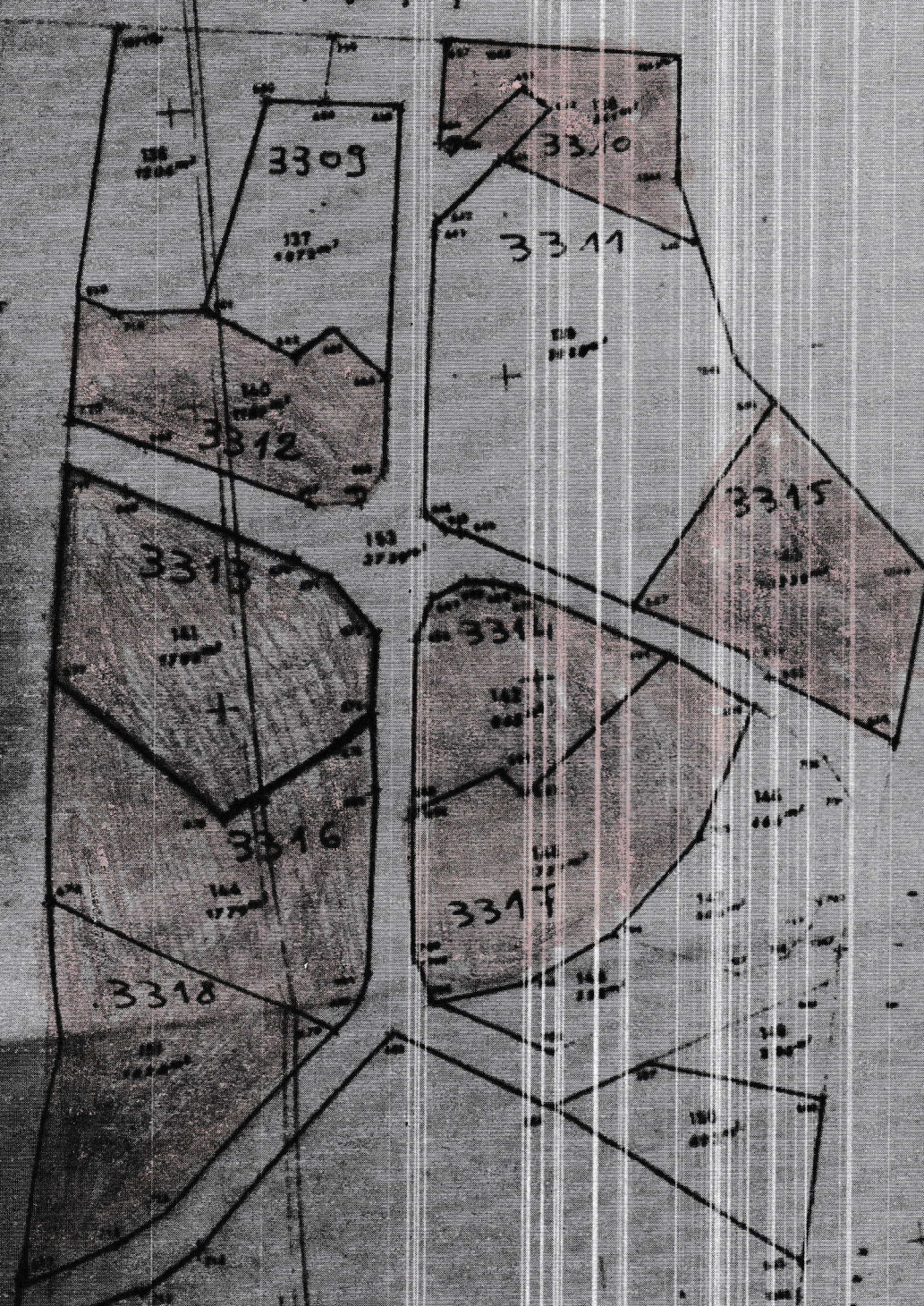

Passavine

Contenance P150 695 m²

152 6073m²

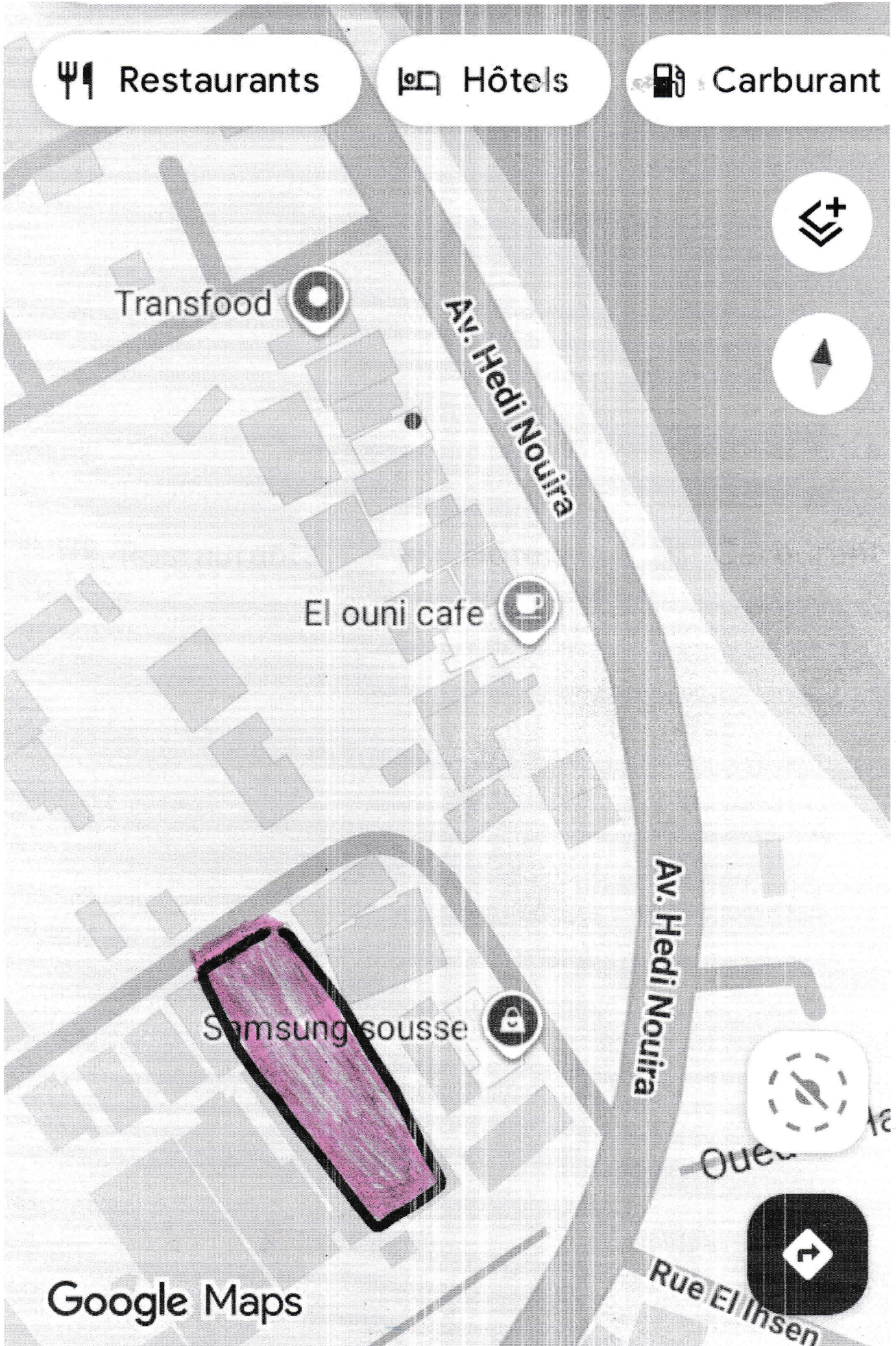

TITRE N
Propriete Dite

NORD

COMMUNE DE SOUSSE (Sidi Abdelhamid)

PPD 107967 T 70498 SOUSSE

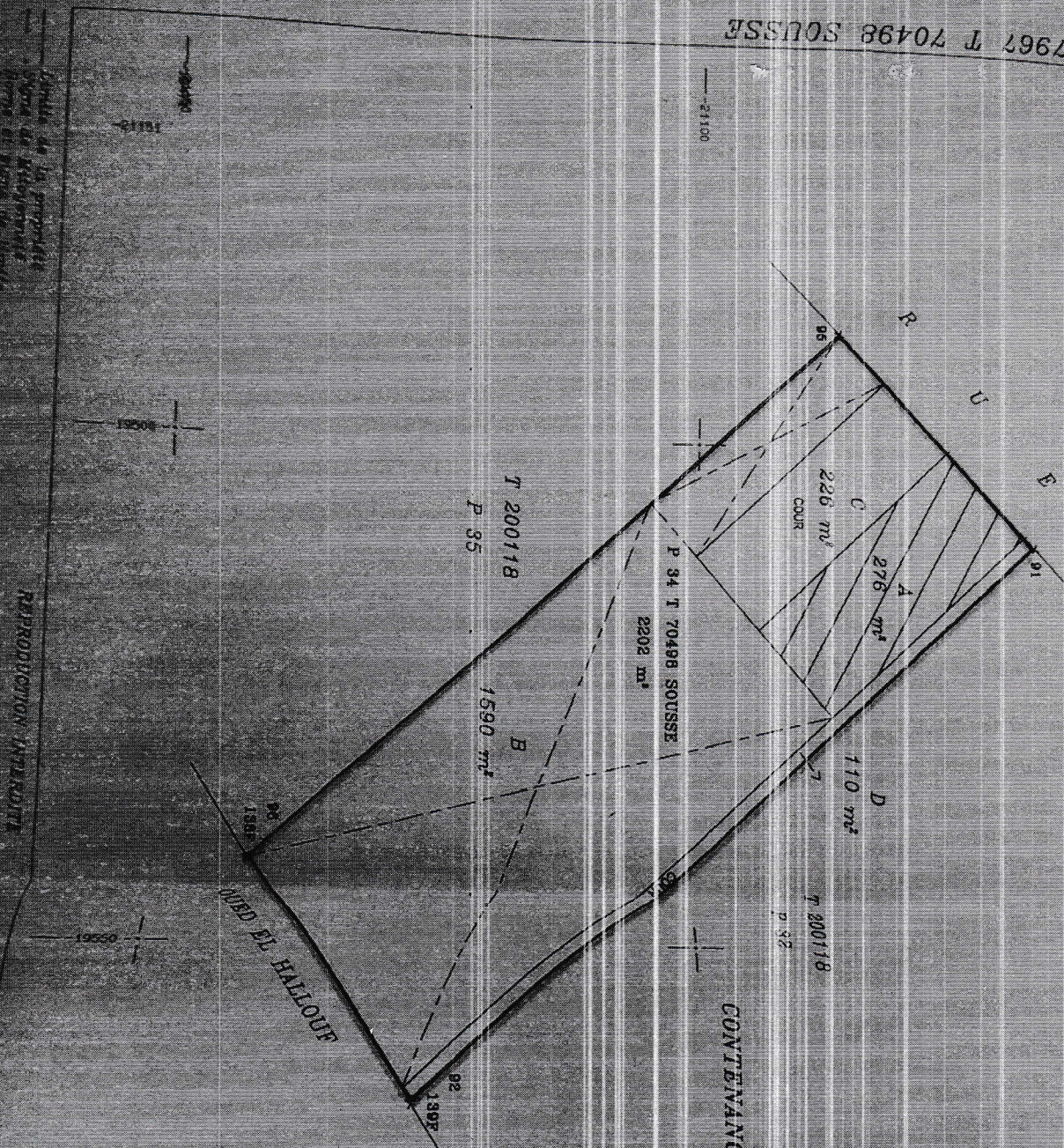

CONTENANCES :

- A = 276 m² BAIE
- B = 1590 m² CONSTRUCTION LEGERE
- C = 226 m² COUR
- D = 110 m² COUR
- SURFACE TOTAL : 2202 m²

Service de la propriété
Bureau de l'Etat
Délivré le 17 Jan 2024

REPRODUCTION INTERDITE

D/R PRÉSIDENT DU DIRECTEUR GÉNÉRAL